

## STRATA UNIT AREA DETERMINATION

### 1. Vertical Development

1.1 The strata area of the principal unit for the vertical development shall be the center of the wall, center of ceiling and center of floor

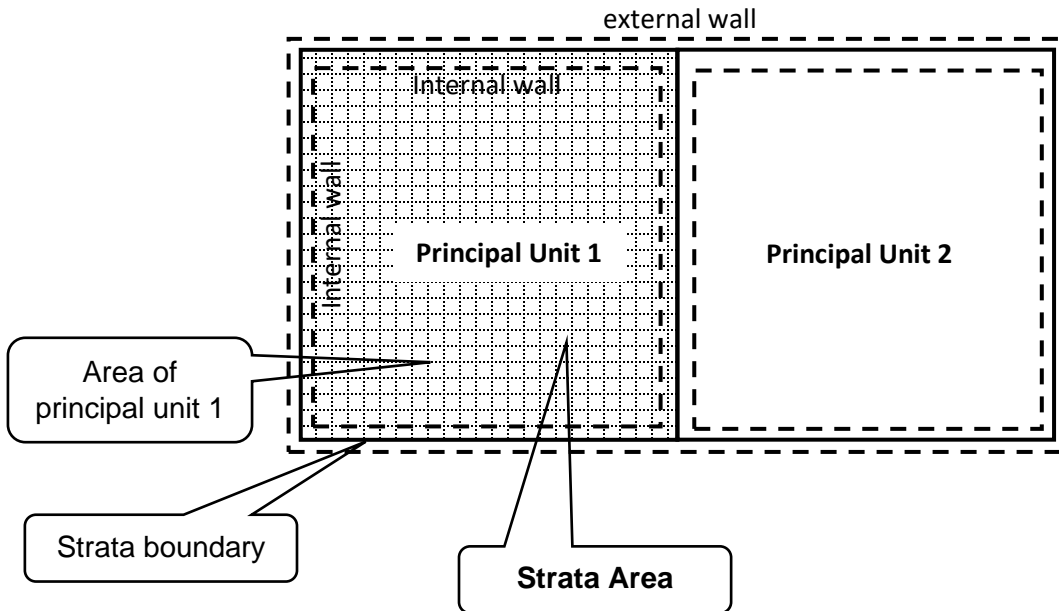

## 2. Landed Development

2.1 Principal Unit boundary for landed development is measured according to the land lot boundary with its height (length x width x height). The height is determined by the height from the lowest level (ground floor or basement) to the height of the roof tip.

### Example 1: Two Storey Detached House

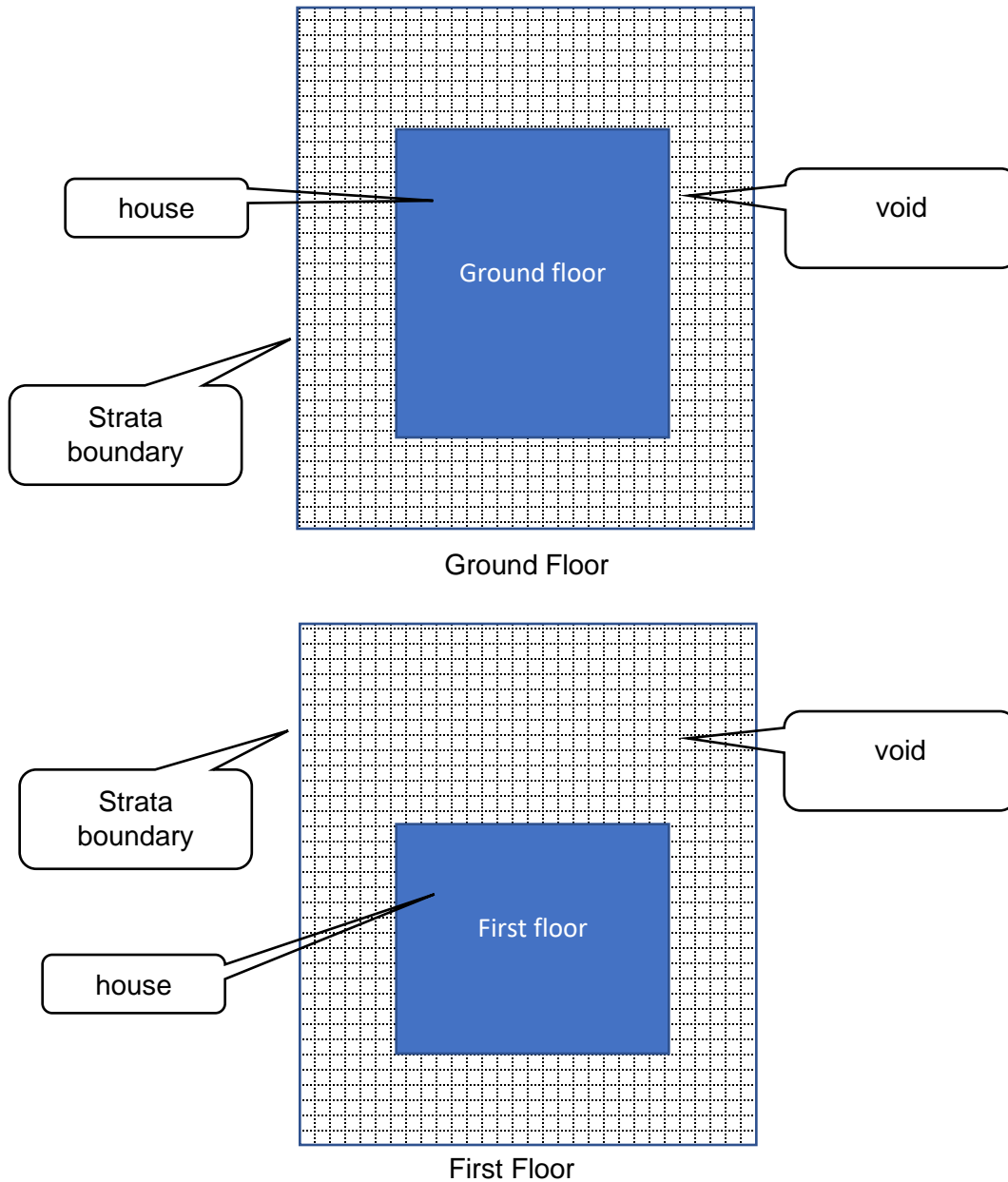

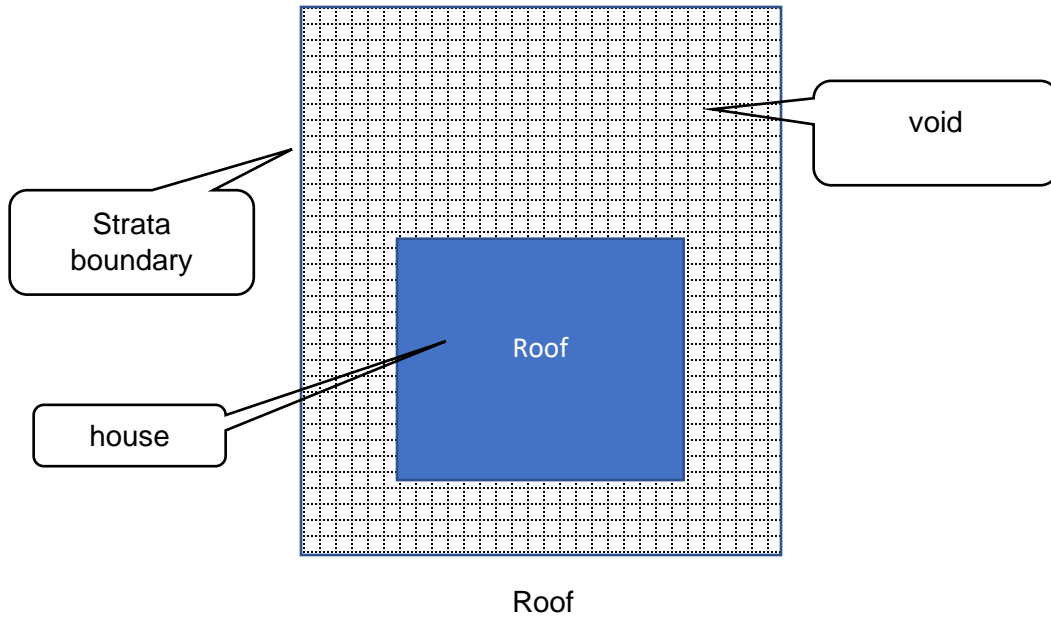

$$\text{Strata Area} = (\text{void} + \text{ground floor}) + (\text{void} + \text{first floor}) + (\text{void} + \text{roof})$$

Example 2: Two Storey Terraced Housing

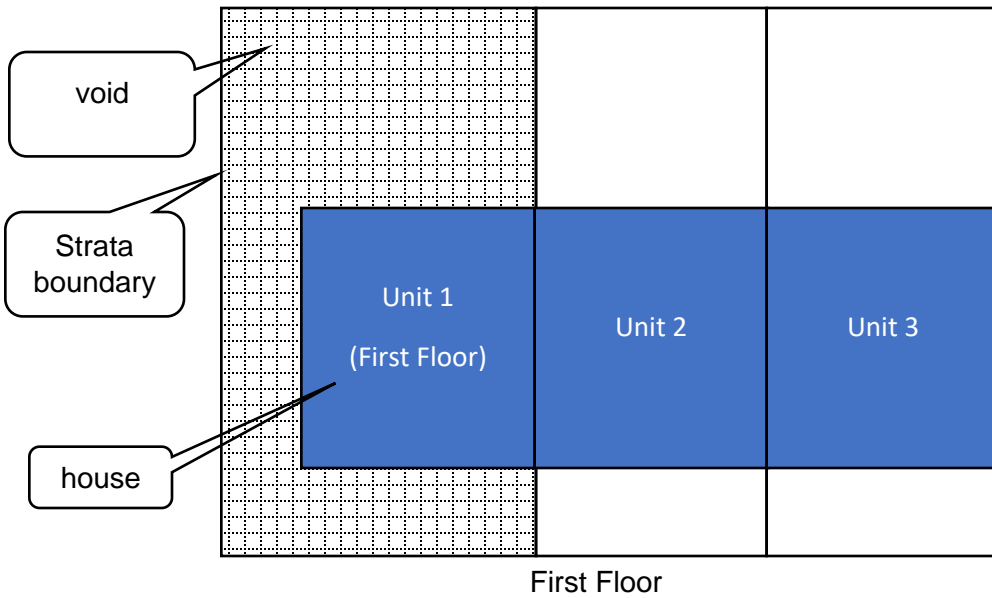
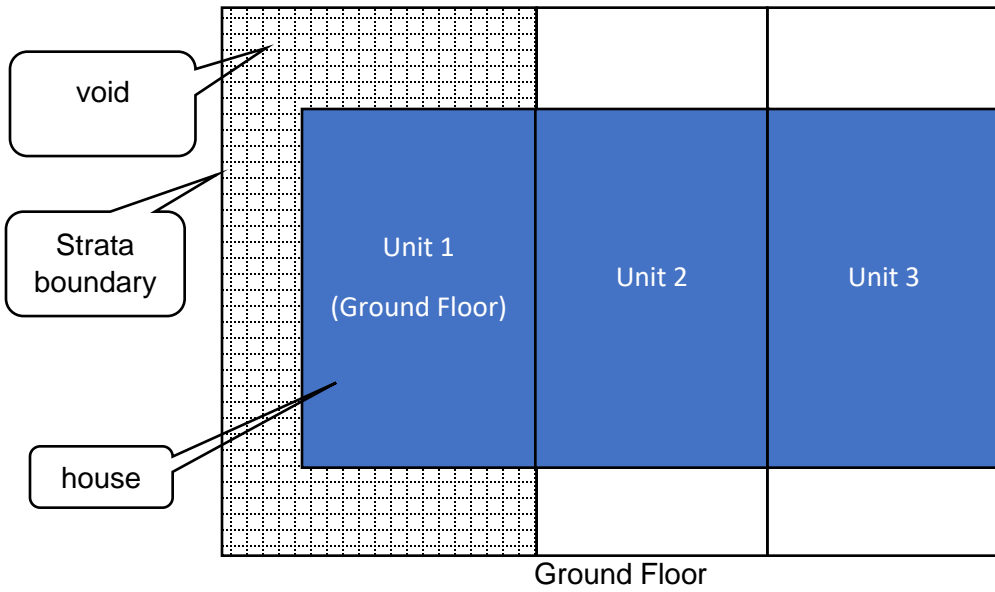

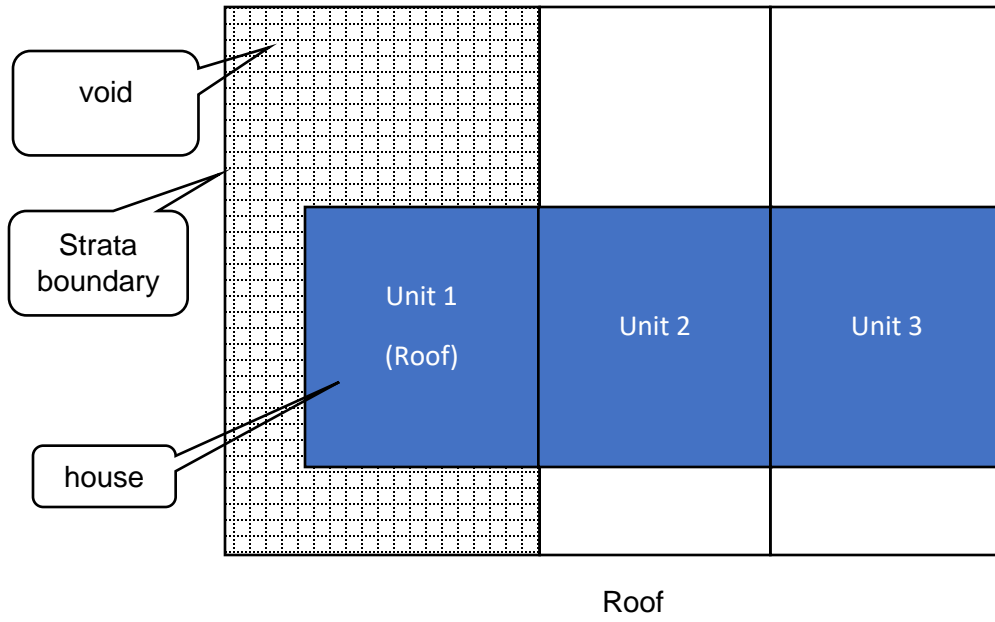

$$\text{Strata Area} = (\text{void} + \text{ground floor}) + (\text{void} + \text{first floor}) + (\text{void} + \text{roof})$$